

KIT PART NUMBER 6234231

INSTRUCTIONS FOR INSTALLING A BREWER BARREL EXTENSION KIT

CHECK THE PARTS RECEIVED IN THE KIT WITH THE PARTS LIST IN THESE INSTRUCTIONS. IF ANY PARTS ARE MISSING, CONTACT NATIONAL VENDORS' PARTS DEPARTMENT IMMEDIATELY.

Read these instructions carefully before installing the kit.
Retain these instructions for part numbers and for future reference.

PART NUMBER	DESCRIPTION	QTY
6234213	Extension - Brewer Barrel	1
6104193	Ring - Quad	1
6234232	Instructions - Installation	1

CAUTION

To prevent personnel injury, disconnect power from the merchandiser while performing these procedures.

INSTALLATION INSTRUCTIONS FOR BREWER BARREL EXTENSION KIT

Refer to Figure 1.

NOTE

If your merchandiser is equipped with the optional ingredient rinse tray, a revised rinse tray, PN 6231481 (Fresh Brew) must be installed to obtain adequate clearance and provide access to hose connections. Use the obsolete rinse tray and Figure 3 as references while cutting a notch in the right rear corner of the revised rinse tray for machines with serial numbers 62390000 thru 62390135, 6259000 thru 62590093, 62310000 thru 62310250, 62510000 thru 62510042, and 62710000 thru 62710774.

1. Remove the hoses from the brewer barrel manifold.
2. Rotate the brewer barrel and manifold assembly 1/4 turn counterclockwise. This aligns the flanges of the brewer barrel with the slots in the brewer support channel. The brewer barrel can then be lifted out of the support channel.
3. Rotate the manifold assembly 1/4 turn counterclockwise from the brewer barrel. This releases the flanges of the barrel from the slots in the manifold assembly.

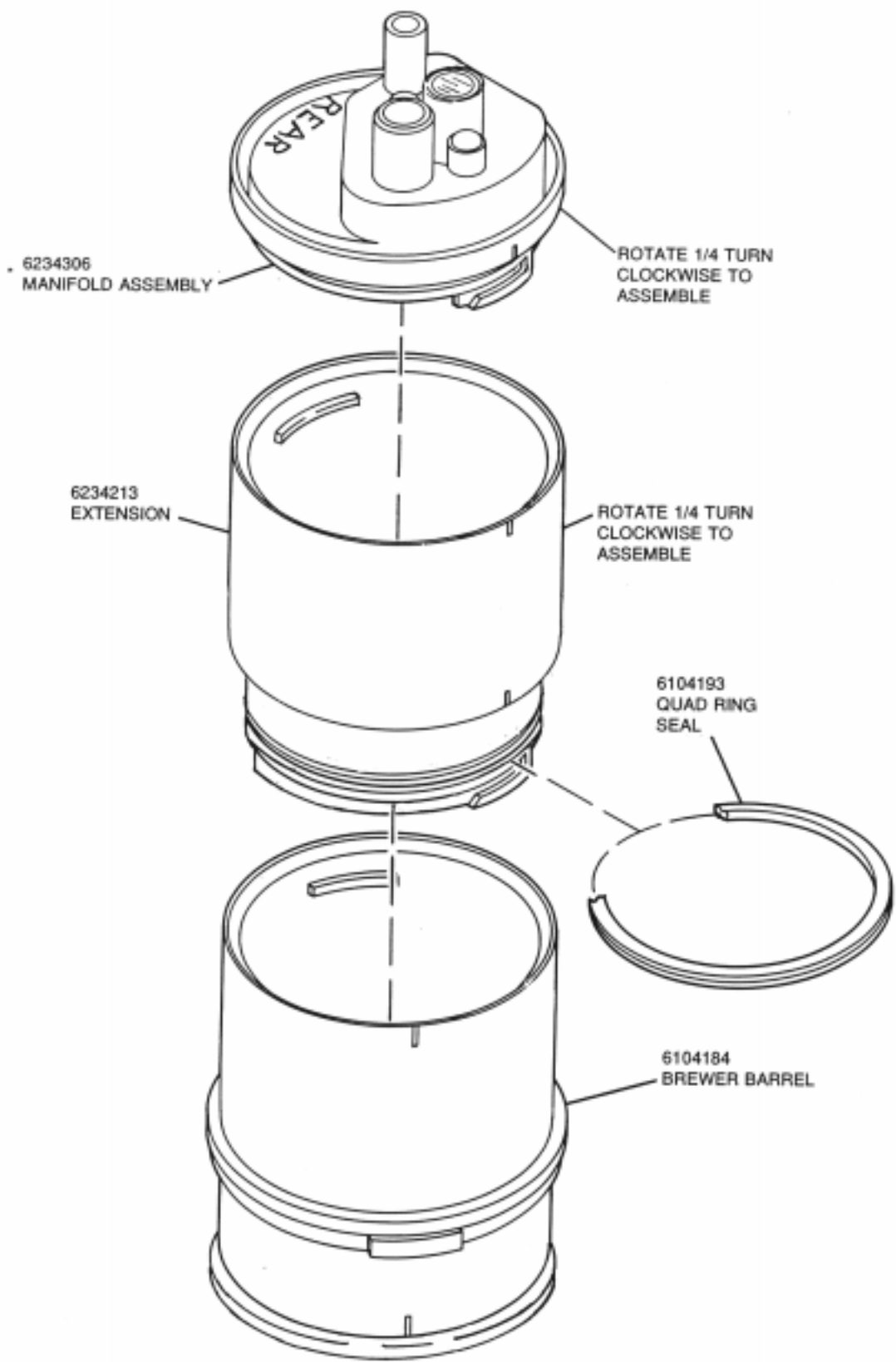

Figure 2.

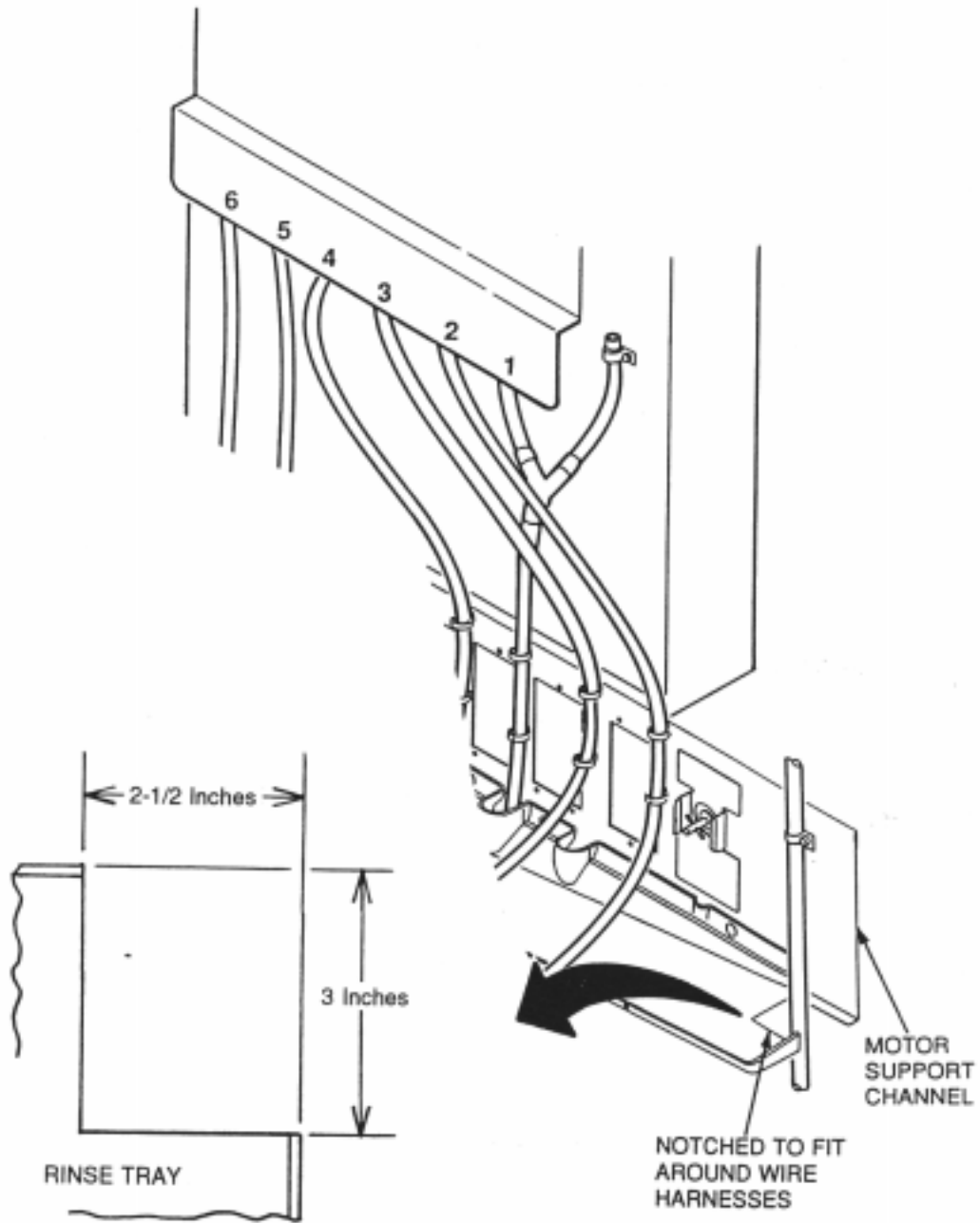

Figure 3.